

HUNTERS®

HERE TO GET *you* THERE



Ghyll Mount

Yeadon, LS19 7GA

£1,350



A delightfully attractive 2 bedroom detached bungalow located in a charming location in Yeadon with stunning views of the picturesque countryside. Excellent transport links are readily available to the nearby cities of Leeds and Bradford

The property comprises of a spacious lounge with a fireplace, a well equipped dining kitchen, 2 good sized double bedrooms, large family bathroom with separate shower unit & 2nd bathroom.

There is a garage with extensive safe and secure off road parking as well as a conservatory.

The spacious garden within a rural setting, the lawns would be maintained by the Landlord.



Area Map



Floor Plans

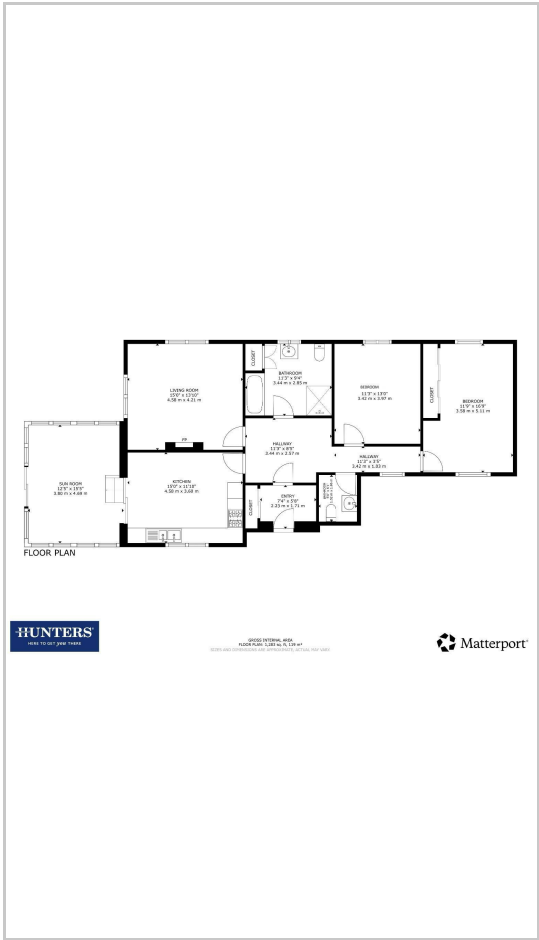

Energy Efficiency Graph



These particulars are intended to give a fair and reliable description of the property but no responsibility for any inaccuracy or error can be accepted and do not constitute an offer or contract. We have not tested any services or appliances (including central heating if fitted) referred to in these particulars and the purchasers are advised to satisfy themselves as to the working order and condition. If a property is unoccupied at any time there may be reconnection charges for any switched off/disconnected or drained services or appliances - All measurements are approximate. **THINKING OF SELLING?** If you are thinking of selling your home or just curious to discover the value of your property, Hunters would be pleased to provide free, no obligation sales and marketing advice. Even if your home is outside the area covered by our local offices we can arrange a Market Appraisal through our national network of Hunters estate agents.